

November Newsletter



From the desk of the Community Manager

As we move into the winter season, the need for housing assistance continually rises. Our team works diligently to ensure that no one in our community faces homelessness alone, but to continue this message, we need your support.

What makes Family Promise of Sussex County unique is that we serve both individuals and families, because we believe everyone deserves a home. Those who have experienced or are experiencing homelessness often share that they feel forgotten by their community or worry others see them as a burden or in a negative light. When they learn that people have donated to the agency to help them, they are moved - reminded that compassion and care still exist right here in Sussex County.

There are many different ways you can help make a difference. You can vote for Family Promise of Sussex County through Target Circle Giving, book a stay at the Ampersand Inn for the Love Your Local Non-Profit month in February, give an in-kind donation for the items we are in need of, or make a monetary donation. You can find more information about each of these ways throughout this newsletter.

Every contribution, no matter the size, helps us provide housing stability to our neighbors in need. Together, we can continue working towards our goal to end homelessness in Sussex County.

Dawn Hendershot, JD

Community Manager
dhendershot@familypromisesussex.org
973-579-1180 ext. 1025

What We're Been Up To...

Family Promise Regional Conference

Our team had the opportunity to attend the Family Promise Regional Conference, where affiliates from across the region came together to share insights, challenges, and innovative solutions in the fight against homelessness.

Throughout the conference, we learned about the common obstacles many affiliates are facing - such as the need for affordable housing, limited shelter resources, and the increasing demand for support services. We also explored new tools and strategies that can strengthen our collective impact and better serve families and individuals in crisis.

It was inspiring to connect with other affiliates and exchange ideas. The conference reminded us that while each affiliate faces unique challenges, we are united by the same mission.

Help Keep Our Neighbors Warm and Housed This Winter

As the cold months approach, more and more of our neighbors are turning to Family Promise of Sussex County for help finding warmth, shelter, and stability. Unfortunately, this winter is shaping up to be one of the most difficult we've faced.

With rising costs of food, utilities, and rent, families who were already living paycheck to paycheck are now finding themselves without a safe place to call home. At the same time, budget cuts and reduced funding are making it harder for our agency to meet the growing need for emergency housing, case management, and other essential services.

Every day, our team works tirelessly to connect individuals and families with shelter, meals, employment resources, and long-term housing solutions - but we can't do it alone.

Your support can make all the difference. Every contribution helps us protect members of our community during these harsh winter months.



Sussex County Warming Centers

Sussex County Division of Social Services 83 Spring Street, Suite 203, Newton, NJ 07860

Monday - Friday	8:30 a.m. - 4:30 p.m.
-----------------	-----------------------

Main Library

125 Morris Turnpike, Newton, NJ 07860

Monday through Thursday	8:30 a.m. - 8:30 p.m.
Friday	8:30 a.m. - 5:00 p.m.
Saturday	9:00 a.m. - 5:00 p.m.

Dorothy Henry Branch

66 Route 94, Vernon, NJ 07462

Monday, Wednesday, Friday	9:00 a.m. - 5:00 p.m.
Tuesday and Thursday	9:00 a.m. - 8:00 p.m.
Saturday	9:00 a.m. - 5:00 p.m.

Franklin Branch

103 Main Street, Franklin, NJ 07416

Monday, Wednesday, Friday	9:00 a.m. - 5:00 p.m.
Tuesday and Thursday	9:00 a.m. - 8:00 p.m.
Saturday	9:00 a.m. - 5:00 p.m.

Louise Childs Branch

21 Stanhope Sparta Road, Stanhope, NJ 07874

Monday, Wednesday, Friday	9:00 a.m. - 5:00 p.m.
Tuesday and Thursday	9:00 a.m. - 8:00 p.m.
Saturday	9:00 a.m. - 5:00 p.m.

Sussex-Wantage Branch

69 County Road 639, Wantage, NJ

Monday and Wednesday	9:00 a.m. - 8:00 p.m.
Tuesday, Thursday, Friday	9:00 a.m. - 5:00 p.m.
Saturday	9:00 a.m. - 5:00 p.m.

Sparta Township Police Department

65 Main Street, Sparta, NJ

24/7 Warming Center

Montague Municipal Building

277 Clove Road, Montague, NJ

Monday - Friday	8:30 a.m. - 4:00 p.m.
-----------------	-----------------------

* Please note that all county offices are closed on county holidays

DONATE NOW

For more information on
how to donate



SCAN HERE



Jimmy & Rosalynn Carter Work Project - Rural Rally

Habitat for Humanity sponsored its first-ever Jimmy & Rosalynn Carter Work Project Rural Rally during the final week of October — a nationwide effort focused on home builds and rehabilitations in more than 17 rural communities across the United States. This important initiative is helping shine a light on the growing need for affordable housing in rural America. Habitat for Humanity is also expanding its work into Sussex County, bringing additional support to help alleviate housing challenges locally.

Family Promise of Sussex County was proud to attend Day 5 of the Rural Rally as part of the Jimmy & Rosalynn Carter Work Project. The event brought together organizations and community members from all over — advocates, volunteers, and partners united in their commitment to addressing housing insecurity in rural communities.

Our team was grateful for the opportunity to connect with others, share resources, and discuss new ways to expand access to safe and affordable homes. We even rolled up our sleeves and joined volunteers on-site, helping restore a home that had been abandoned for forty years!

Family Promise of Sussex County is excited to continue supporting this momentum and collaborating with Habitat for Humanity and community partners to ensure every individual and family in our region has a place to call home.



We're a Target Circle participant. Vote for us.

Voting runs from October 1st - December 31st

Target Circle members earn votes by shopping at Target, either in-store, online, or on the app.

1. Open the Target app

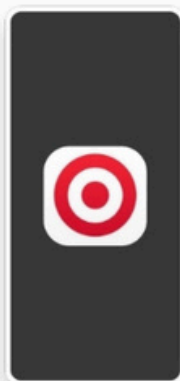

2. Tap "My Target", bottom right

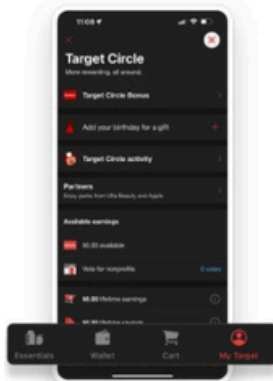

3. Tap "Vote for nonprofits"

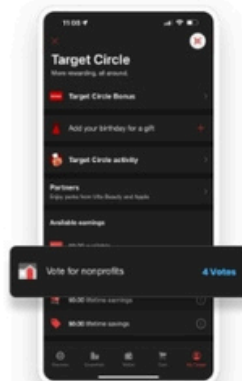

For More Information



SCAN HERE



February is

LOVE YOUR LOCAL NON-PROFIT MONTH

In an effort to support non-profit organizations in Sussex County, the Ampersand Inn has designated February as "Love Your Local Non-Profit," month.

During February, room revenue will be distributed to Sussex County non-profit organizations selected by guests.

- ♥ All rooms are offered at a highly discounted rate of \$100/night (2-night minimum on Friday/Saturday) and \$200/night on Valentine's weekend.



Valentine's Weekend
(Fri, Sat, Sun)
Super Bowl Sunday

February 2026

Donate
\$100
per night**

Donate
\$200
per night**

**2-night minimum on weekends

HOW IT WORKS

- ① Book a room online (ampersandinn.com) or by phone (973-300-0395)
- ② Provide credit card info to hold the booking (you will NOT be charged)
- ③ Check in and donate directly to the Sussex County non-profit of your choice

Call or Book Online
Starting Nov 1, 2025

*Sussex County non-profits exclude political or religious organizations. Businesses that wish to match or contribute should email the Inn directly.

Fun things to do in February

- Visit Lakota Wolf Preserve
- Take a Tour of Sterling Hill Mining Museum
- Experience Winter Sports at Mountain Creek Resort
- Cross Country Ski in Kittatinny Valley State Park
- Visit High Point State Park and Its Monument
- Admire the Natural Beauty of Buttermilk Falls